

Converter systems SIMODRIVE 611

Overview of the drive system

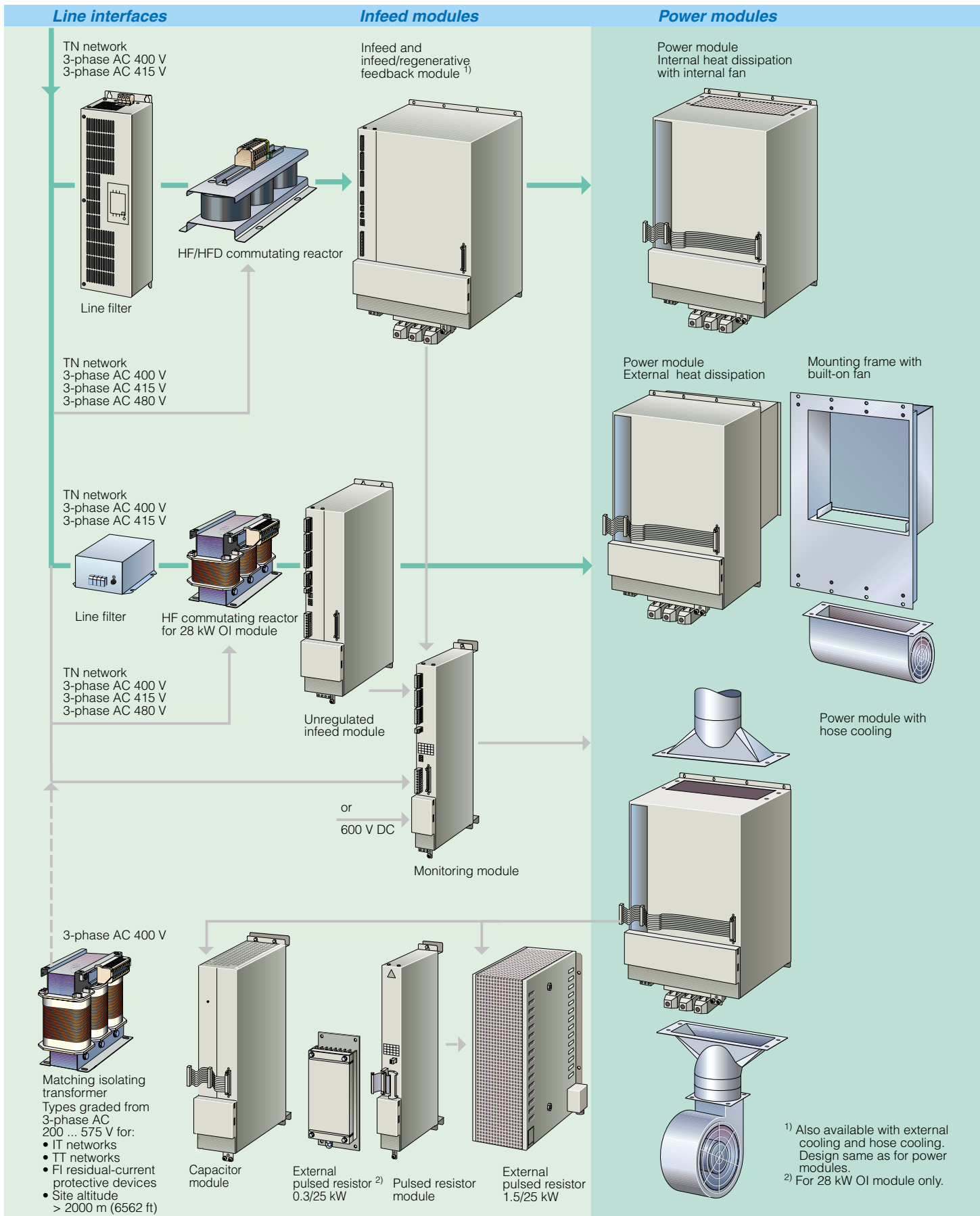

Control units

Control units with analog setpoint interface/PROFIBUS

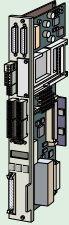

For 1FT6/1FK/1FN/1FW6/1PH/2SP1/1FE1 motors and induction motors

- Single-axis version (with resolver only)
- Two-axis version (resolver and motor encoder)
- Standard: analog setpoint interface
- Option: PROFIBUS

Control units with digital setpoint interface

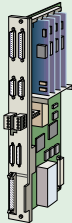

For 1PH/1LA or 1FT6/1FK motors

- Two-axis version (High Standard control)
 - For motor encoder
 - Additional measuring system for voltage signals

For 1FT6/1FK/1FN/1FW6/1PH/2SP1/1FE1/1PM motors

- Single-axis version (High Performance control)
 - For motor encoder
 - Additional measuring system for voltage signals
 - Two-axis version (High Performance control)
 - For motor encoder
 - Additional measuring system for voltage signals
- EnDat + SSI

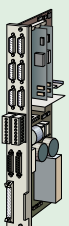

For hydraulic linear axes (HLA) or analog axes (ANA)

- Two-axis version

Motors

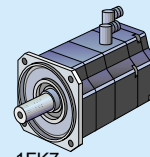

1FK7

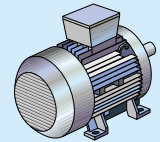

Induction motor,
e.g. 1LA

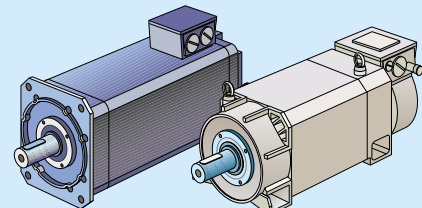

1PH4

1PH7

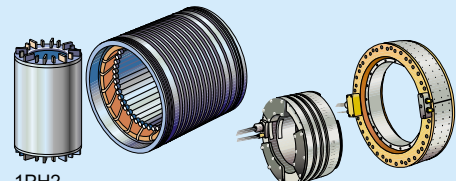

1PH2

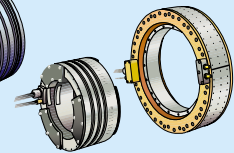

1FW6

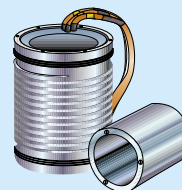

1FE1

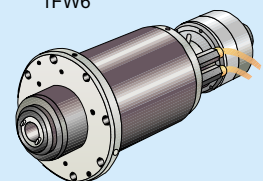

2SP1

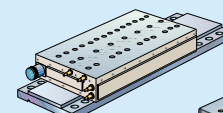

1FN1

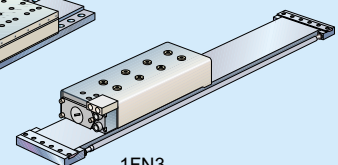

1FN3

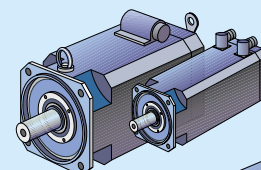

1FT6

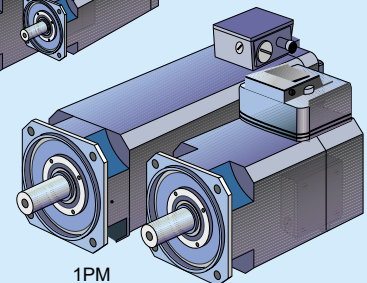

1PM